

32 778 000 EUROECO MONOMANDO DE LAVABO 1/2"

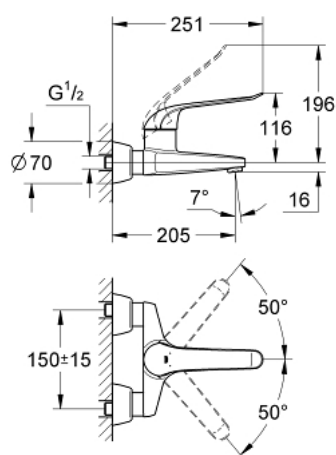

DESCRIPCIÓN DEL PRODUCTO

- Color: Cromo
- Montaje mural
- GROHE SilkMove Cartucho de discos cerámicos 46 mm
- Caudal máximo a 3 bars: 8 l/min
- Limitador de caudal ajustable
- Limitador de temperatura ajustable
- Aireador
- Caño fijo de fundición
- Longitud del caño 205 mm
- Palanca metálica
- Longitud de la palanca 170 mm
- Racores en S

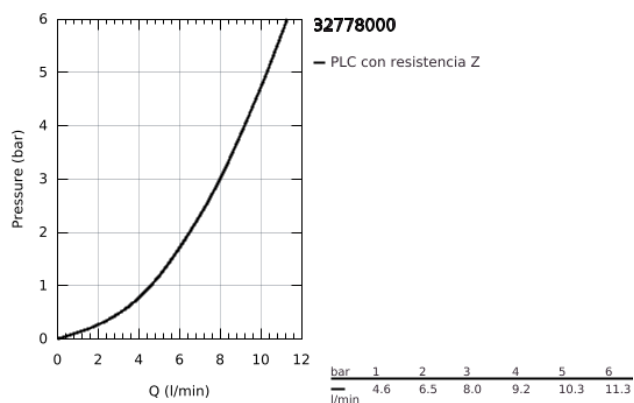

This exploded view diagram illustrates the assembly of the microscope. The main body (1) is shown with various components being attached. Part 2 is the eyepiece, which is inserted into the top of the main body. Part 3 is the objective lens, which is also inserted into the top. Part 4 is the objective lens holder, which is attached to the side of the main body. Part 5 is the base, which is attached to the bottom of the main body. Part 6 is the stage, which is attached to the front of the main body. Part 7 is the stage clip, which is used to hold the slide in place. Part 8 is the slide, which is placed on the stage. Part 9 is the cover slip, which is placed over the slide. Part 10 is the stage micrometer, which is used for measuring the size of the specimen.